



Floating Island

Exclusive Venue in Seoul

Iconic landmark on the Han River with impressive architecture and versatile spaces.

Host unforgettable events in the heart of Seoul.

History

1

2006

The mayor of Seoul envisioned an iconic landmark similar the Sydney Opera House, for the city as part of the Han River Renaissance project. The citizen-led idea to build an artificial island was selected. The project began in 2006.

2

2009

Construction began on the foundations of 'Somesevit', a floating platform. Designed with concrete and steel, it was built to withstand the river currents and weather conditions. This artificial island comprises three distinct islands and a multimedia art gallery.

3

2014

The Floating Island was officially inaugurated, featuring three themed islands and a multimedia art gallery. The largest island is designed to host international conferences and events.

4

Present Day

The Floating Island has become an iconic destination for events. Over the past 10 years, we have hosted numerous significant events, consistently offering state-of-the-art facilities, impressive views, and exceptional services and experiences.



Privileged Location

Accessible by public transportation

Transportation	Distance	Time
Metro (Lines 3, 7, 9)	500m	5 min
Bus	200m	3 min
Water Taxi	On site	Immediate
Airport Limousine	1 km	1 hour

Nearby Attractions and Hotels

Destination	Distance	Time
JW Marriott	700m	19 min
Hyatt Hotel	3km	12 min
Shila Hotel	7km	17 min
Coex	7km	30 min

Parking

Get 3 hours of free parking for up to 900 vehicles.



Moonlight Rainbow Water Fountain

The Banpo Bridge, with 380 nozzles spraying water down from the river, creates a beautiful display of water, music, and lights. The fountain is programmed to perform different shows during the day and night. The Rainbow Fountain is installed along 570m on both sides of the Banpo.

During the day, the fountain shows a hundred different configurations intended to evoke the movement of willow branches and leaves. When the sun sets, 200 lights illuminate the fountain while it launches dancing jets of rainbow-colored water into the air synchronized with music. It operates every day from April to October, four to six times a day for 30 minutes.

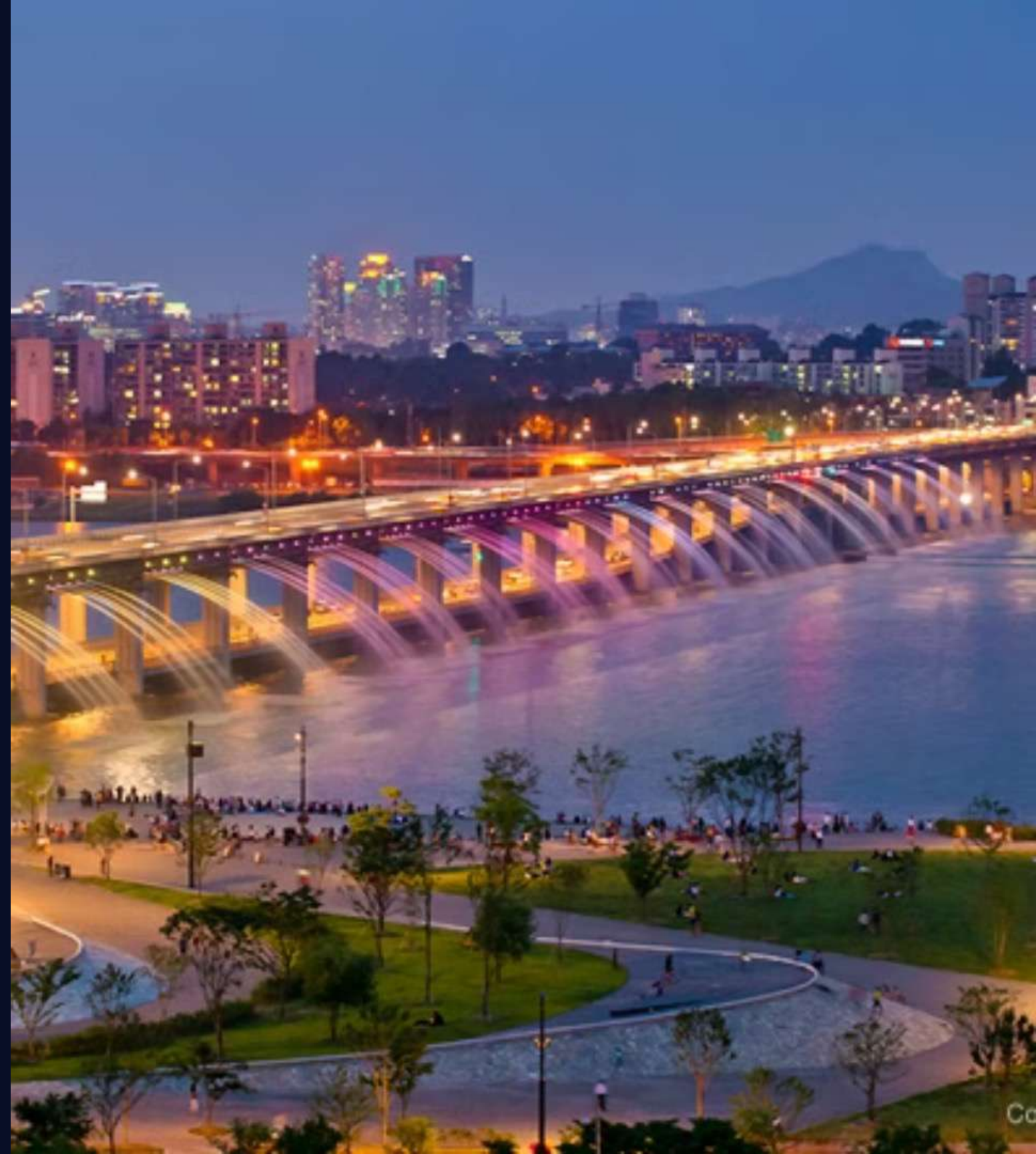

Versatile Space



Floating Island

The Floating Island is equipped with state-of-the-art facilities to host any event. It has seven spaces of different sizes and offers a unique and memorable experience for your event.



Anniversary Hall

Celebrate a special occasion in the beautifully designed Anniversary Hall, which includes a lobby, main hall, and reception area.



Marina Park

Marina Park, which was the setting for the famous movie "Single in Seoul", has indoor and outdoor spaces. Plan your event with the impressive Han River Marina Park as the backdrop.



Floating Island

1

State-of-the-Art Facilities

Advanced audiovisual equipment and high-speed internet.

2

Riverside Location

Its prime location on the Han River offers impressive views and a serene atmosphere.

3

Cultural Landmark

A fusion of tradition and innovation that reflects the dynamic spirit of Seoul.

**2F Total Space
(1202m²)**

~~Convention hall
(762m²)~~

Deck

Villa de Noche
(321m²)

Lobby

CONVENTION  컨벤션을

Deck

VIP rom²om
(109m²)



Villa at Noche

Welcome Area

An elegant and impressive space, ideal for VIP meetings and exclusive events.

Lounge Spaces

Impressive river views from floor-to-ceiling windows. Perfect for networking and relaxation.

Private Terrace

Designed for intimate gatherings, enjoy stunning views and fresh air on this private outdoor terrace.

Exclusive Reception



Excellence in MICE Events

Exceed your expectations with a first-class experience.



State-of-the-Art Technology

Our advanced audiovisual equipment and high-speed Wi-Fi ensure seamless presentations and connectivity for your event.



Networking Spaces

The Terrace is designed to foster meaningful connections and promote friendly interaction among attendees.



Custom Decorations

Our team of experienced professionals can create customized decorations that perfectly fit your event's theme and needs.

THE CONVENTION HALL

Area: 762m²

Capacity :

Theatre – 800 pax

Round – 550 pax

Classroom – 500 pax

Standing – 1000 pax

USAGE

- Banquets
- Business Party
- Launching Events
- Performance
- International Symposiums

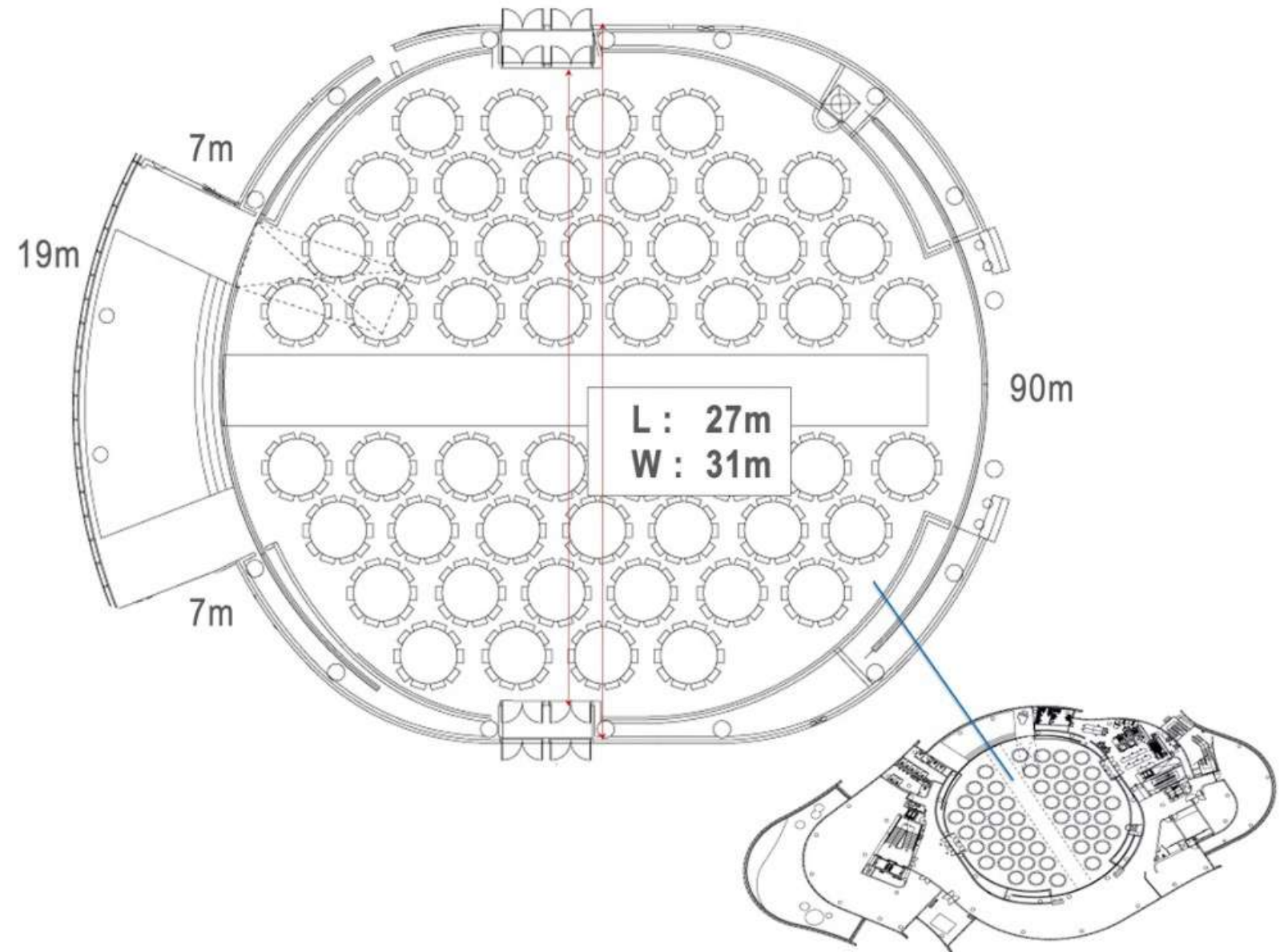

Gala Dinner

Discover the pinnacle of event spaces in our convention hall, with an impressive capacity for 500 people. From banquets to international symposia, host your extraordinary events with us !

1 Elegant Dining Hall

Utilizing dome ceiling and sophisticated space tailored to match your gala's theme and style.

2 In-house Catering

Offering customizable menus to suit a range of dietary needs, crafted by top chefs for an unforgettable dining experience.

3 Impeccable Service

Highly trained staff dedicated to ensuring a flawless and luxurious event.



References from past Gala Dinners

Our facilities offer flexible and modern spaces that adapt perfectly to any type of event. From corporate meetings to special celebrations, each space is designed to provide an exceptional experience.



Conferences



Our convention center has over 762 square meters of conference and meeting space, complemented by advanced technology and a dedicated team of event planning executives. This makes Floating Island one of the most sophisticated venues in Seoul for corporate conferences and conventions.



Whether it's a gala dinner or your company's first in-person brainstorming session, Floating Island can help you create exceptional events that reflect the new world.

High-Profile Conferences. Success

With its exclusive domed ceiling that extends a stunning 13 meters, our conference space offers a truly unparalleled experience. The absence of pillars creates a wide-open canvas, ideal for projecting visual elements, transforming your event into a dynamic and creative spectacle. Our standard configuration includes a 45-meter-wide screen with a resolution of 20,000 Ansi, ensuring impressive clarity for multimedia presentations and displays. Coupled with high-quality audio equipment, we guarantee flawless operations for every event. It can accommodate approximately 1,000 guests in a classroom-style arrangement.

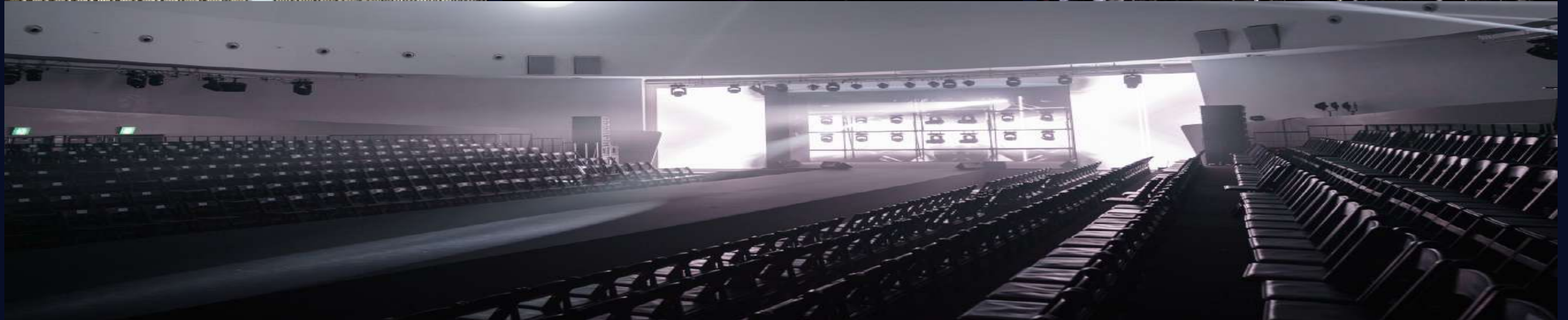

Medical Seminar



Previous Seminars and Conferences

- 2015 WFSICOM – The Pursuit of Excellence in Critical Care
- 2015 WAC
- 2015 Accelex Seminar
- 2015 BMS – Bristol Myers Squibb
- 2016 Digital Dentistry Conference
- 2019 IEEE MEMS Conference
- 2019 International Renewable Energy Conference
- 2019 Twitter #4Brands Marketing Event
- 2019 Ferrari, Cadillac, and Mercedes-Benz Media Events
- 2019 U.S. Independence Day
- 2022 France's Bastille Day Celebrations
- 2024 New York State Bar Association Global Conference





Car Launch

What sets our convention center apart is its unique feature: an innovative lift system that can elevate cars directly into the hall, an extraordinary convenience not commonly found in convention centers. This distinctive attribute adds a touch of exclusivity and facilitates impressive product launches, automotive exhibitions, and immersive brand experiences.

With its massive size, exceptional amenities, and unparalleled capacity, our convention center promises to create unforgettable moments and set the stage for extraordinary success.

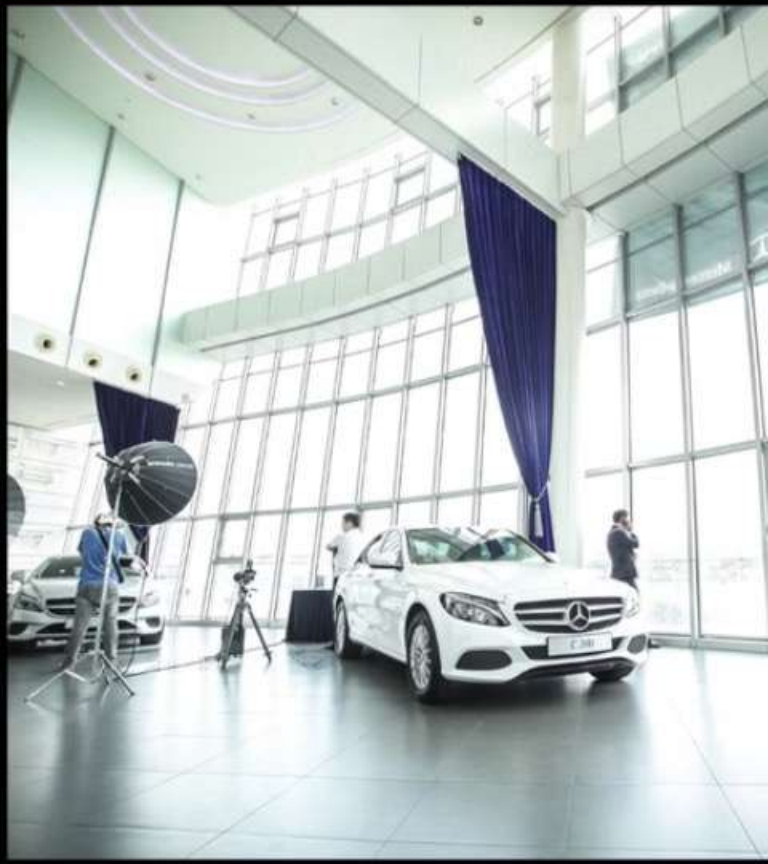



Ferrari 488 GRB

The Ferrari 488 GRB is a high-performance sports car with a powerful engine and elegant design.



Chrysler

The Chrysler is a reliable and stylish sedan known for its comfort and practicality.



Project Events

The Floating Island convention is a versatile space that can adapt to the needs of your event. From VIP parties to intimate gatherings, create unforgettable experiences with customized areas. This space is also ideal for conferences, exhibitions, launches, demonstrations, and more.





Vibrant Festive Atmosphere

1

Miller launch

Ideal for large-scale celebrations with over 1,500 guests.

2

Fashion Show

The latest Louis Vuitton designs on the runway.

3

Exhibition

A platform for musical performances and new brand launches.

Louis Vuitton Pre-Fall 2023 Show

The stunning Louis Vuitton Cruise collection runway show took place on the Han River in Seoul, showcasing the brand's commitment to unforgettable experiences. The models walked the floating runway, with the iconic Floating Island and Moonlight Rainbow Fountain as the backdrop, creating a captivating fusion of fashion and architecture. The event highlighted the brand's dedication to blending luxury with the city's unique beauty.



Music Showcase

Elevate your events with captivating live music performances, refined lighting, and a state-of-the-art sound system for an unforgettable experience. Immerse your guests in the energy of a live performance, creating an atmosphere that lingers long after the final note. Our venue is designed to provide an unparalleled audio experience, whether for a solo artist or a full band. Partner with us to create a truly unforgettable exhibition experience.



International Event



America Independence day



Republic Day of India



Brand on the Bridge

1 High Visibility

A high-traffic area for guests entering or leaving the venue, offering excellent visibility for brand messaging theme and style.

2 Large Display Spaces

Ample space for hanging large posters and banners along the bridge railings, maximizing branding impacts and allowing for creative and dynamic displays

3 Photogenic Backdrop

Positioned over the Han River with a view of the island and surrounding cityscape, the bridge provides a scenic background, elevating visual effects.

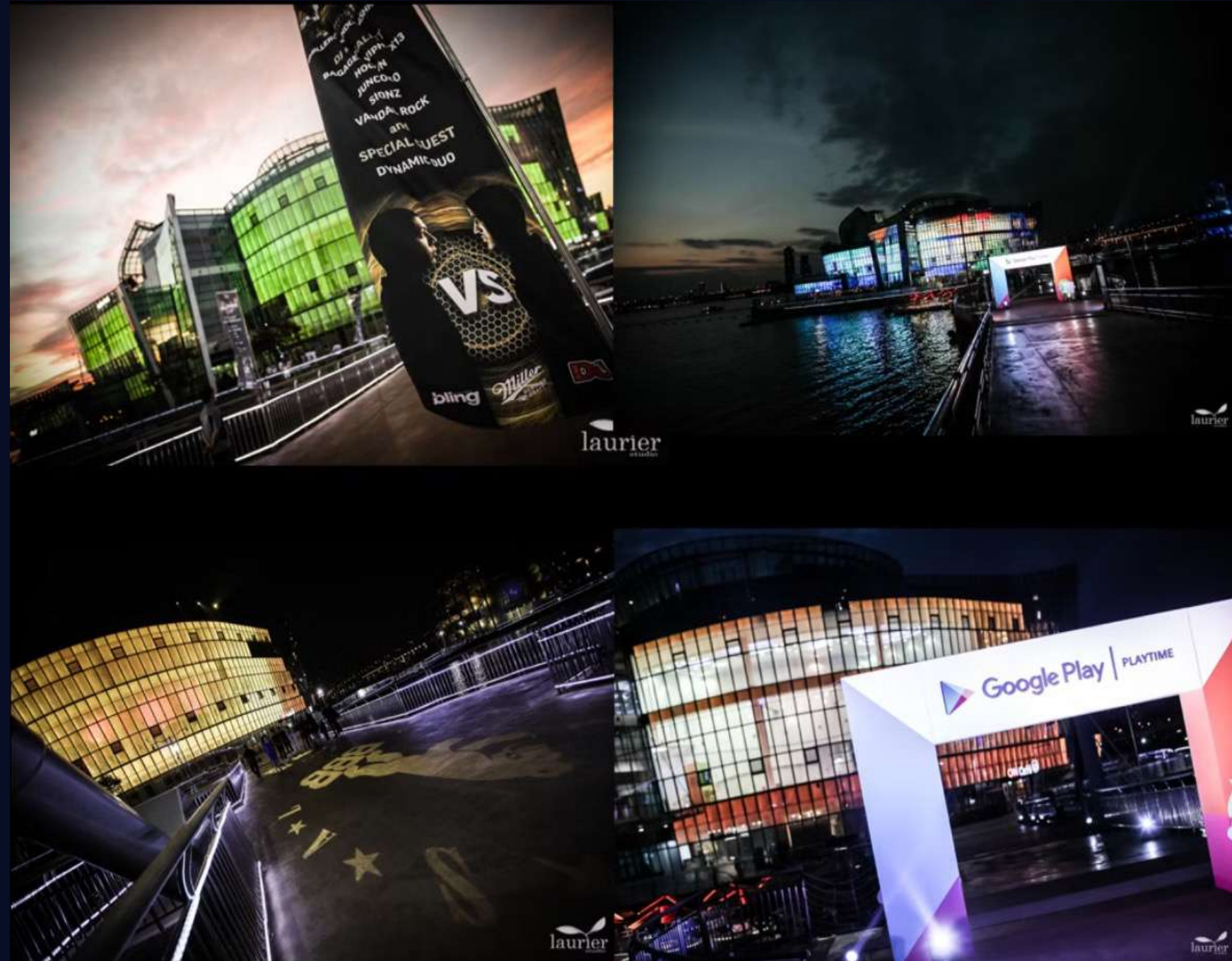

Media Art Gallery

As guests arrive at your event, they can view the Multimedia Art Gallery from the parking lot. This area is perfect for capturing photos and videos to commemorate your event.



Traditional Performance

THE CONVENTION HALL IS THE LARGEST BANQUET HALL FOR LARGE-SCALE INTERNATIONAL CONFERENCES, GALA DINNERS, AND OTHER EVENTS, AND CAN ACCOMMODATE UP TO 600 PEOPLE



3F Floor Plan

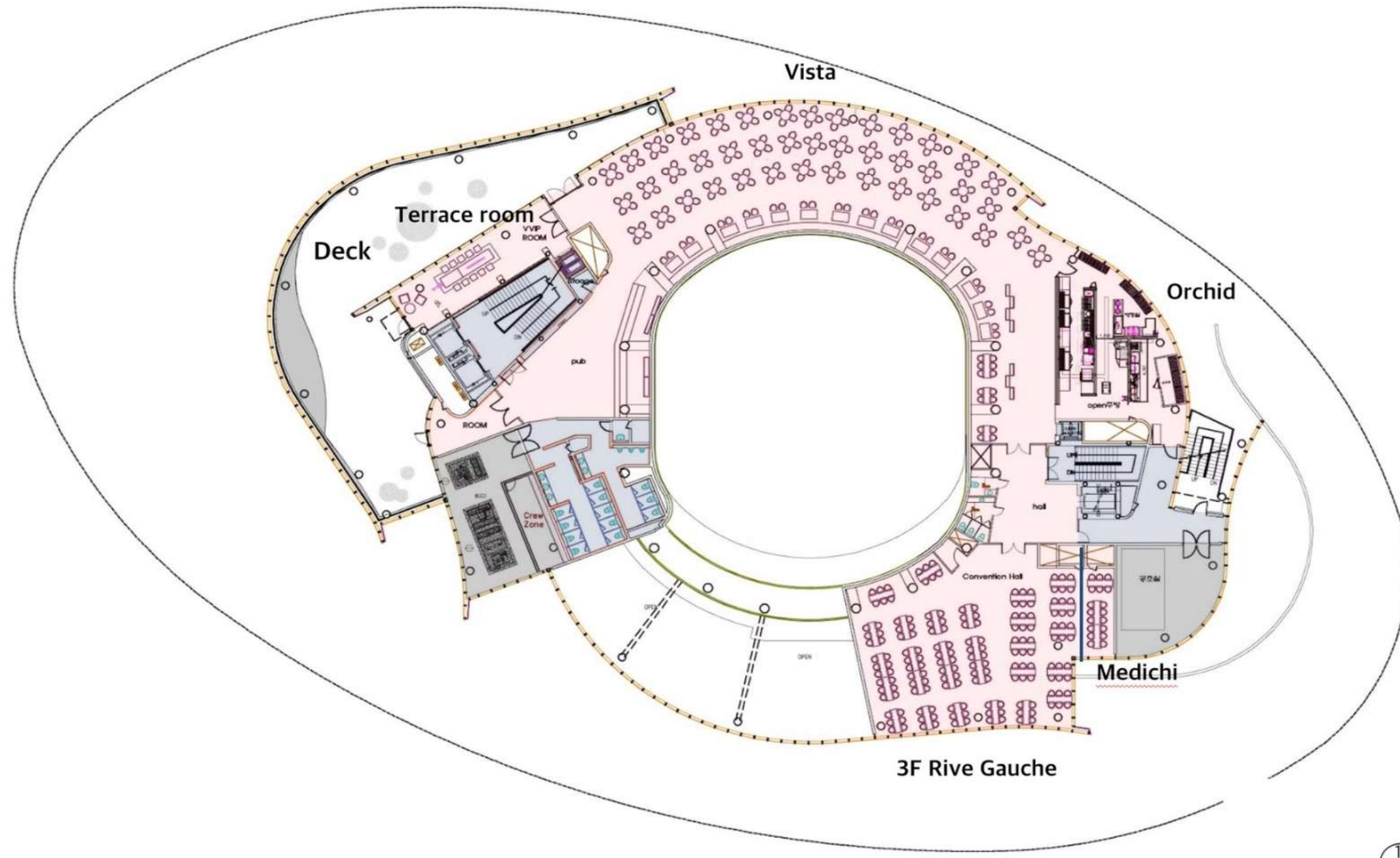

3rd Floor Vista

The View is located on the third floor and offers a panoramic view of the Han River.

Approximately 250 people can enjoy dinner here. This floor has a portable stage with two wide screens for videos and presentations. Guests also have access to a private terrace next to the View.



Expansive Event Space



Flexible Design

Adaptable for conferences, galas, and exhibitions.



Panoramic Windows

Natural light and impressive views of the Han River.



Advanced Technology

Integrated audiovisual systems for perfect presentations.

Rive Gauche

Rive Gauche is also located on the third floor. It has its own lobby, elevator, and restrooms. There is a beautiful view of the rainbow fountain on the Banpo Bridge from the windows. The fountain operates every 30 minutes starting at 6 pm. This area has a capacity of 100 to 120 people.

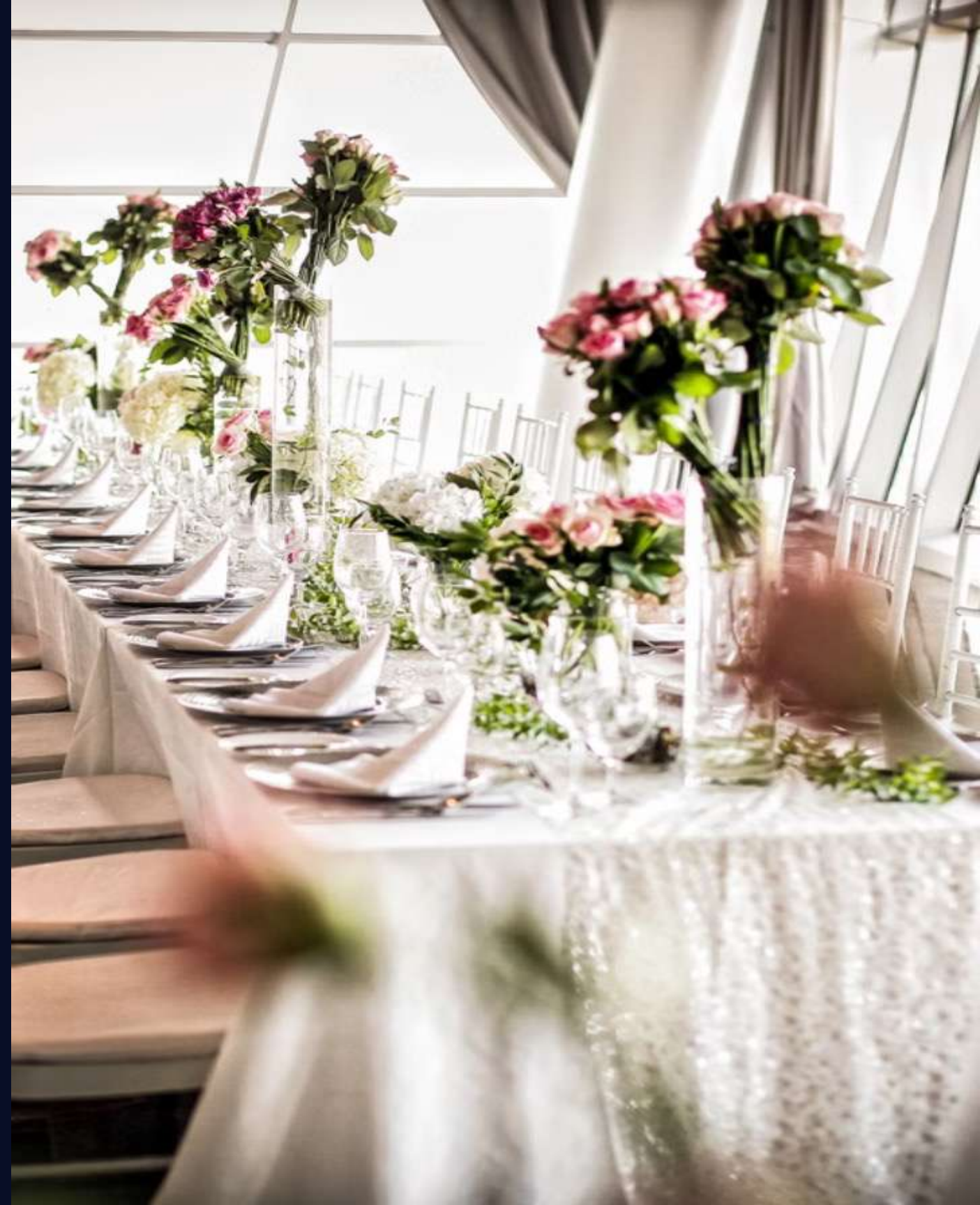



Medichi

This room can accommodate 10 to 18 people. The Medichi room boasts a sophisticated ambiance, perfect for a private dinner, a small business meeting, or a special occasion where a touch of exclusivity is desired.



Orchid

This room is perfect for intimate meetings and offers stunning views of the river. Its floor-to-ceiling windows provide panoramic views of the Han River, creating a serene and naturally lit atmosphere.



Terrace Room

This terrace room is an event space for 10 to 30 people.

This private and quiet room is ideal for seminars, private dinners, or wine parties.



Extravagant ways to celebrate the day. Elegant food always seems to taste better when accompanied by a great view and fresh air. People are having fun at the dinner on the terrace. What makes the terrace room so special is that we have a special balcony that provides people with more freshness from the outdoor area and, of course, the impressive view of the river.



4th Floor Plan

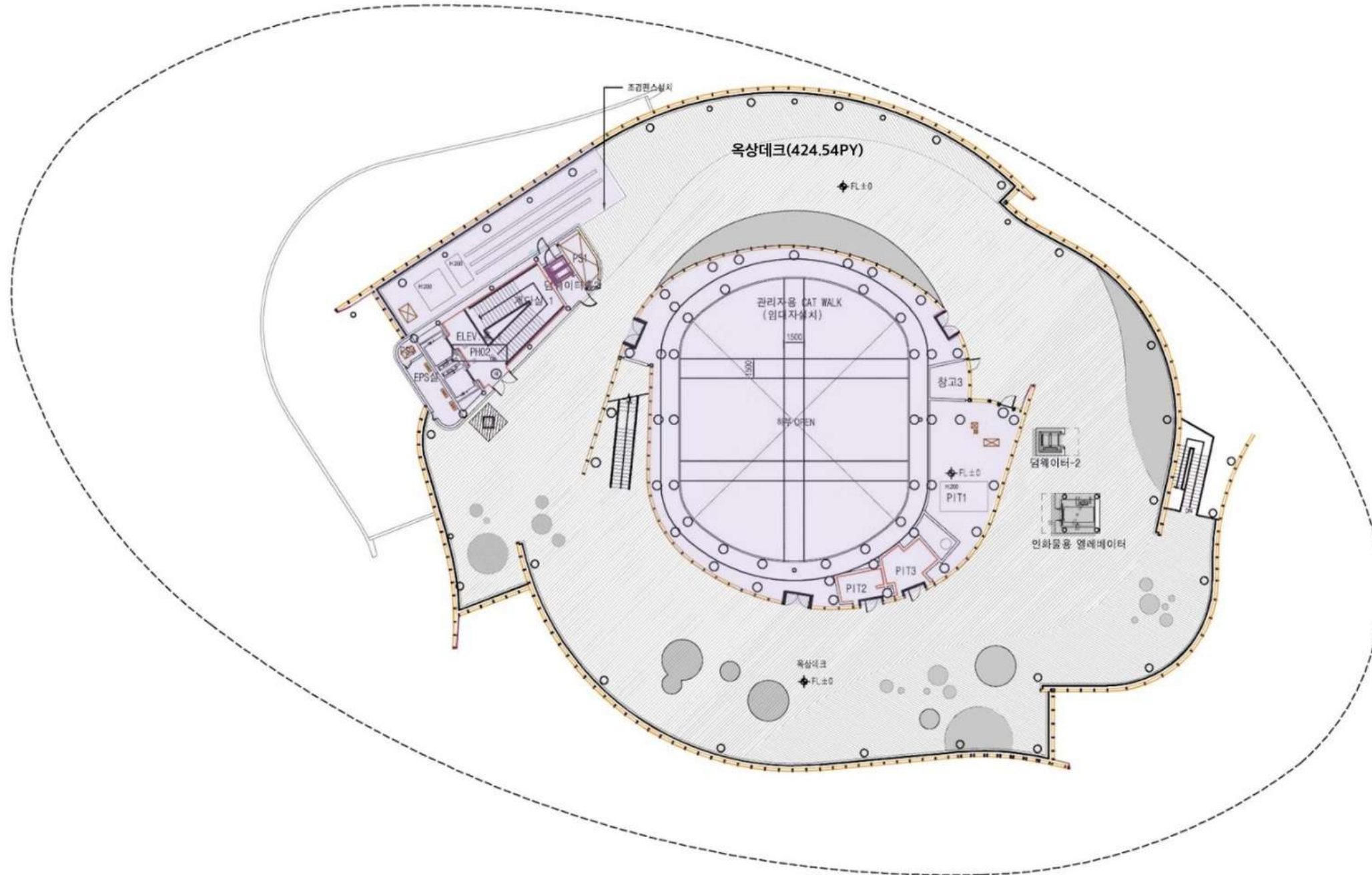

4F Terrace on the Bay

1

Panoramic Views

Unobstructed panoramas of the Han River and cityscape.

2

Outdoor Dining

Perfect for outdoor receptions and cocktail events.

3

Versatile Space

Suitable for daytime and nighttime events.

4

Natural Ambiance

Lush vegetation and open-air atmosphere.



The outdoor garden on the terrace next to the bay on the fourth and fifth floors is an excellent place to host events.

200 seats can be arranged under the canopy, and guests can take in the Namsan Tower and Yeouido at a glance. It is also an ideal location for cocktails or dynamic events such as the Korean Culture Experience and fireworks displays.



Casual event



5F Floor Plan

The fifth floor is used for weddings, but it is also excellent for other events such as DJ parties and special events. It is a wonderful experience for your guests.

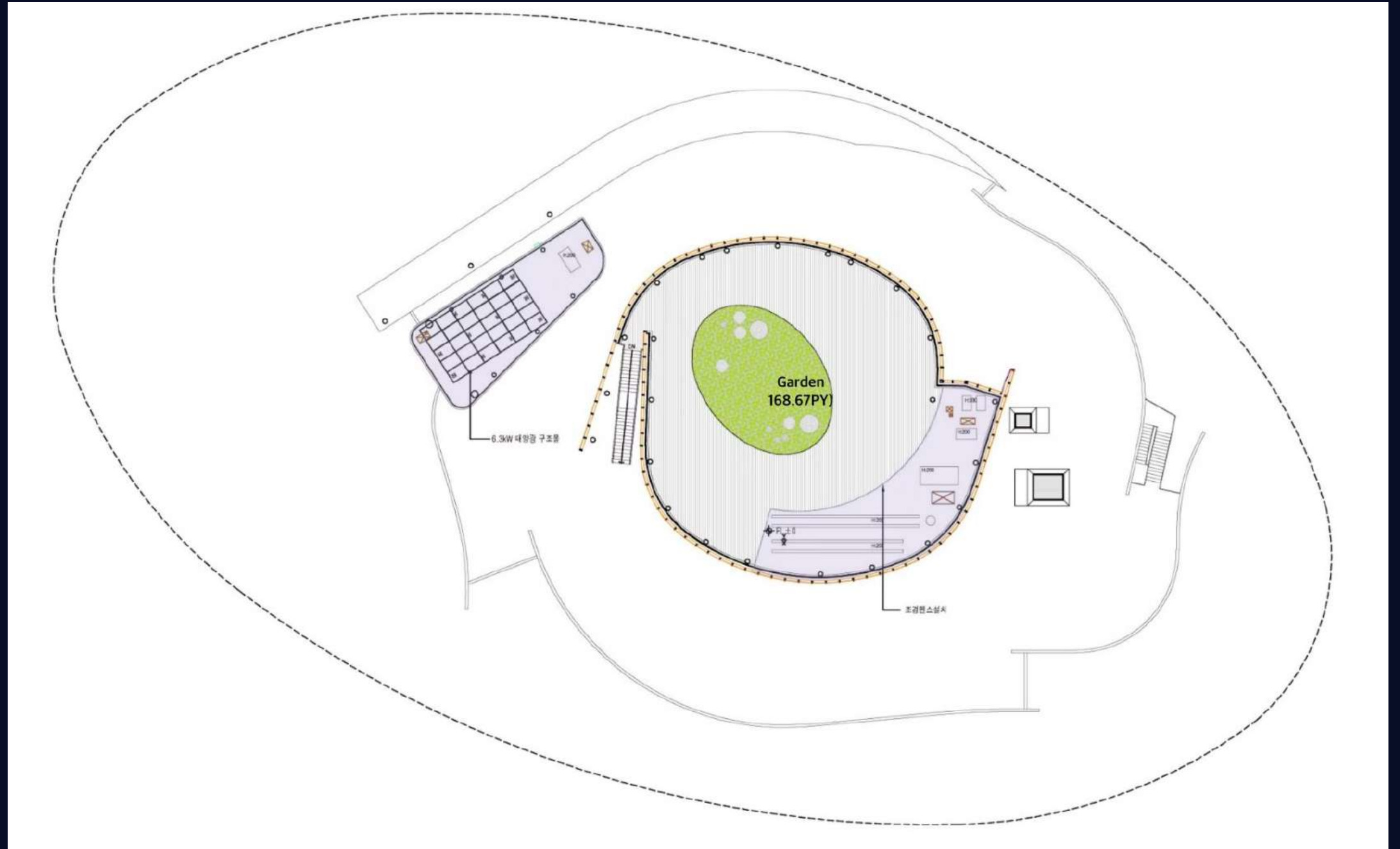

5F Garden: Rooftop Oasis

- 1 Tranquil Setting
Escape from urban bustle with greenery and water features.
- 2 Intimate Gatherings
Ideal for small receptions and networking events.
- 3 Photo Opportunities
Picturesque backdrops for memorable event photography.





BY FLOATING ISLAND

ICONIC SPACE
ANNIVERSARY





Modern Design

Our space incorporates contemporary architectural elements with large windows that allow natural light to enter, creating a welcoming and dynamic environment for our visitors.

Sustainability

The building integrates sustainable features such as solar panels and natural ventilation systems, demonstrating our commitment to the environment and energy efficiency.

Conferences



Brand Launching



Pop up Stores



MARINA PARK

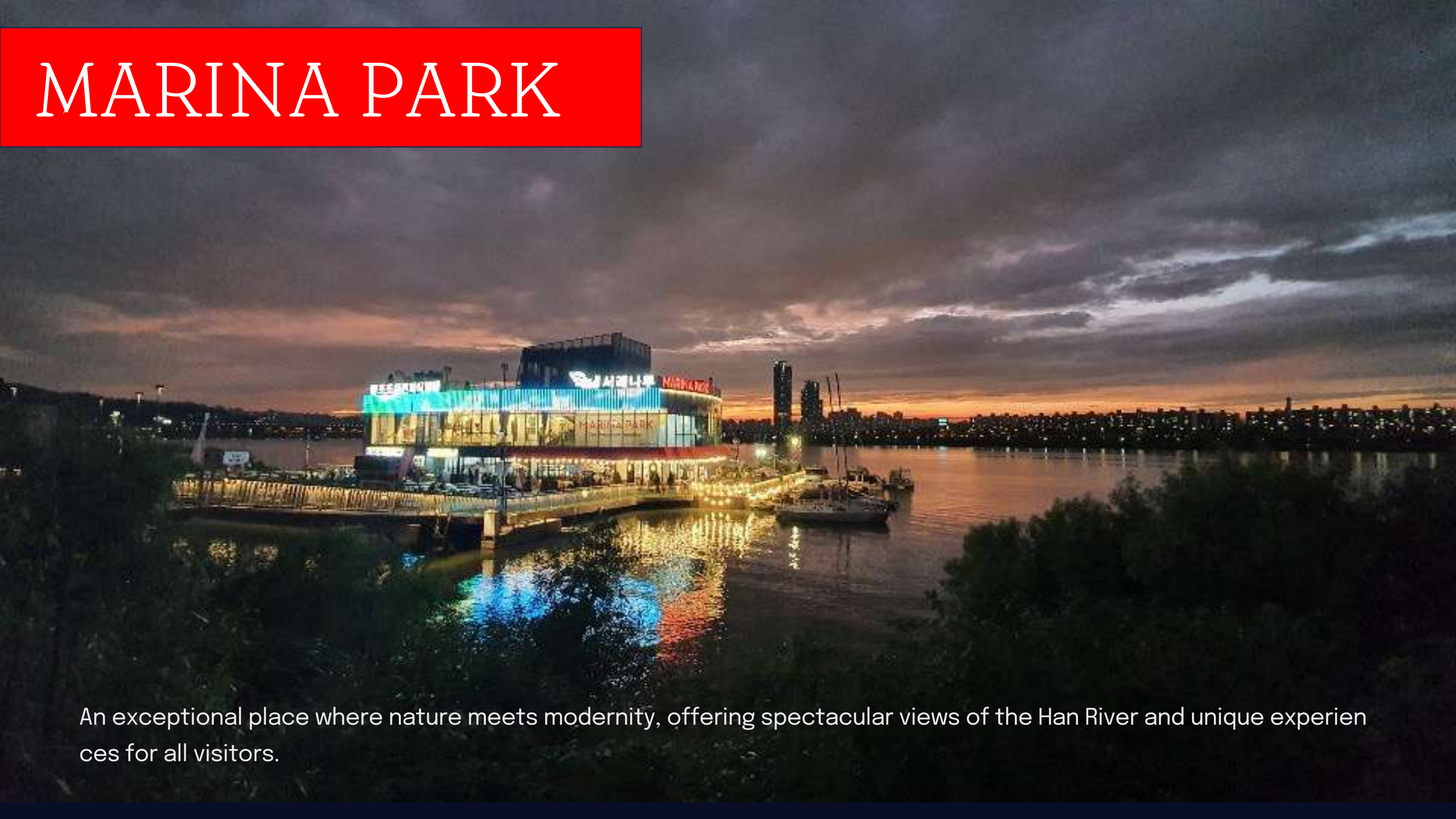

An exceptional place where nature meets modernity, offering spectacular views of the Han River and unique experiences for all visitors.

Marina Park

Waterfront venue – a variety of events

Located in the Banpo Han River Zone, Marina Park offers a serene oasis in the heart of bustling downtown Seoul. With its impressive natural beauty and eco-friendly design, this seaside location provides a captivating setting for a variety of events. Experience the charm of spectacular fountains, dazzling light displays, and refreshing breezes from the Banpo Bridge, creating an extraordinary ambiance. Marina Park is proud to feature Seoraenaru, an exclusive floating dock for taxis as part of the prestigious Han River Renaissance Project, allowing visitors to embark on an unforgettable journey along the river, surrounded by the ever-changing colors of the sunset. Let Marina Park be your gateway to a truly distinctive experience, where cherished moments become eternal memories.



Event History



- 2018.12 Indonesia National Day
- 2018 Duuple Asia Launch Event
- 2019 GSM Party
- 2019 Unicity Global Leadership Innovation
- 2019 Nextiv - Lagrisser Game Launch Show
- 2019 SM Town - MICE JAPAN
- 2019 World Air Force Chief of Staff
- 2019 War Gaming Launch Show
- 2019 Abbott Conference Dinner
- 2022 Ministry of Patriots and Veterans Event
- 2022 Galderma Korea
- 2022 Merck Life Science SLS
- 2023 Exo Pongdeug Event
- 2023 Prudential Indonesia

Exterior

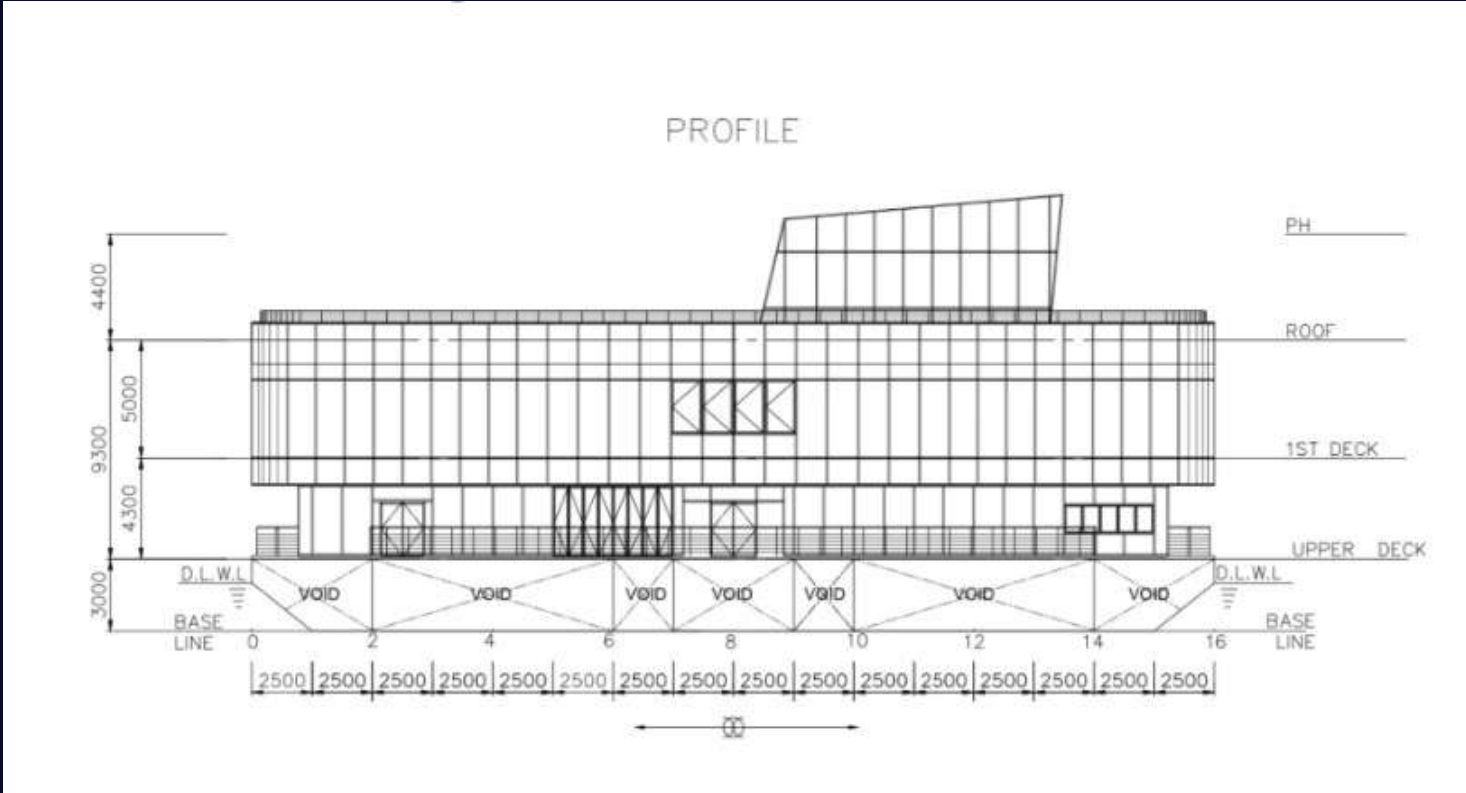

Layout

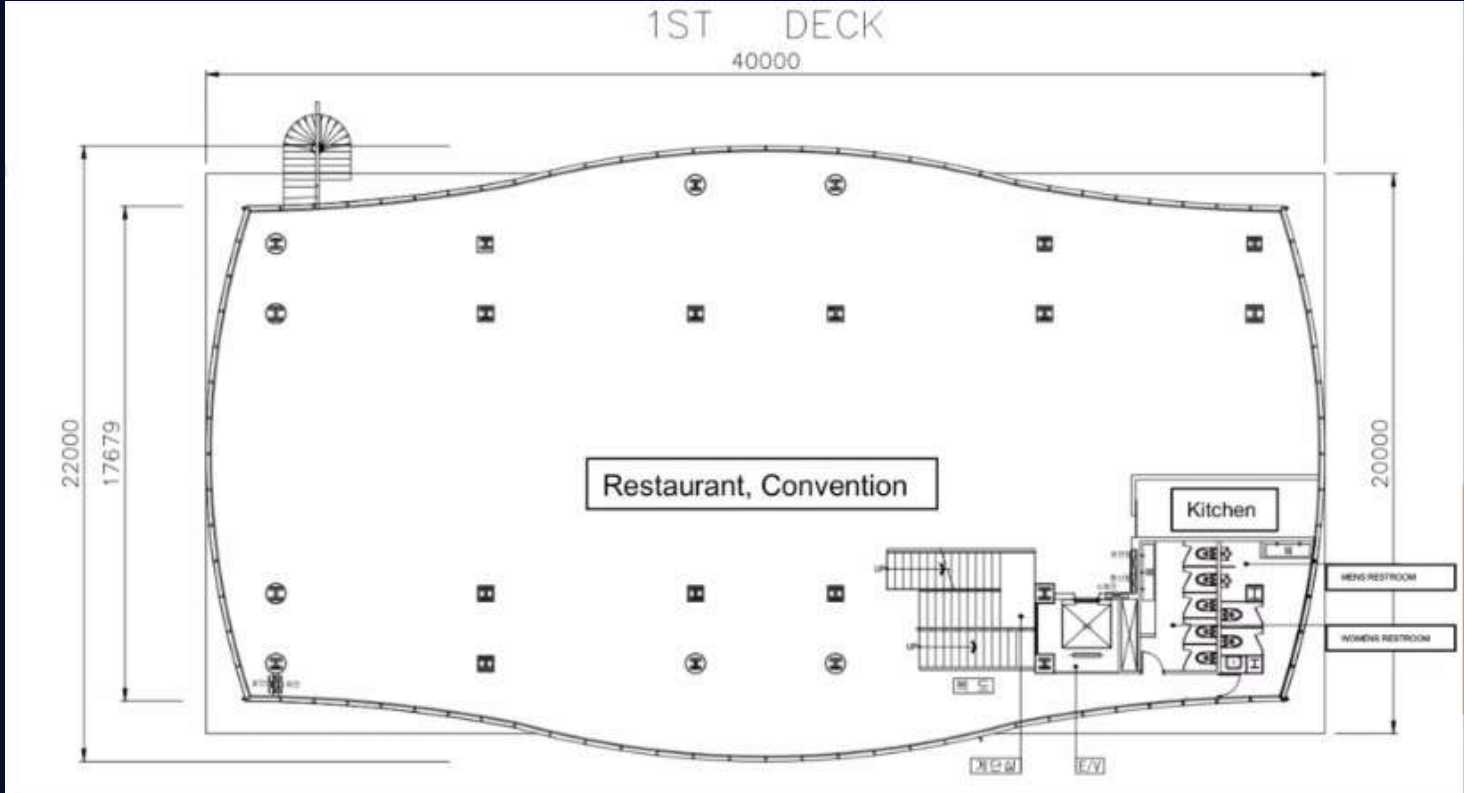

Flexible Space

Key Features

Marina Park consists of two interconnected floors, with the convention area on the second floor being the main event space, and the rooftop garden on the third floor serving as a reception or party area before or after the event. In some cases, smaller parties or informal events can use only the third floor.

Location	m ² (Pyeong)	Standing	Round Table	Theater Style
1F Café Marina	66.284 m ² / 80	150	100	
2F Convention	876 m ² / 200	400	300	500
3F Rooftop Garden	876 m ² / /200	300	250	

The Great View

Experience the pinnacle of luxury and sophistication by hosting your event at one of Korea's iconic venues. With stunning views of the Han River, city lights, and captivating water fountain displays.



Conference. Gala Dinner



Rooftop Garden - Evening Event



Memorable Moments

A collection of special moments captured during our exclusive events





Culinary Excellence

Cuisine Type	Specialties	Service Style
International	Fusion dishes, local delicacies	Buffet, plated service
Gourmet	Collaborations with Michelin-starred chefs	Tasting menus
Dietary Options	Vegetarian, vegan, allergy-free	Customized menus